



**S1GP**  
**PRO**

**OWNER'S MANUAL**

# S1GP

## PRO

### INTRODUCTION

### ABOUT NHK S1 GP PRO SERIES

### HELMET SPECIFICATION

### HELMET PARTS DESCRIPTION

#### 1. AIR VENTS / VENTILATION SYSTEM

#### 2. SUN VISOR

#### 3. VISOR / SHIELD

#### 4. PINLOCK PIN

#### 5. RETENTION SYSTEM ( STRAP ) \*

- MICROMATIC BUCKLE
- DOUBLE D RING

#### 6. NHK HELMET INNER LINING

- CHEEK PADS
- CROWN PAD



\*) Please check your production series, some model might be different.

\*) If you have any inquiry, please send your email to : [info@nhkhelmet.com](mailto:info@nhkhelmet.com)

## INTRODUCTION

Thank you for purchase of your new **NHK S1 GP PRO** helmet. This helmet has been designed and created to be modern, futuristic and high performing product. This NHK helmet is made possible by the helmet design, its ergonomic, comfort and aerodynamic properties as well as its practical and easy to use controls. NHK S1 GP Pro bring the new racing technology into daily urban style

Please read this manual carefully before use and keep it for future reference. This manual contains valuable information to help you understand all the function of manual contains valuable information to help you understand all the function of the product and the instructions how to use your NHK helmet for more safety and comfortable use.

## ABOUT NHK S1GP PRO SERIES

**NHK S1 GP PRO** is one of our stylish street helmet that equipped with dual visor technology and also long rear spoiler. **NHK S1 GP PRO** is created with Advanced Thermo Polymer Shell that comes with comfortable inner lining system for maximum air vent system, cool feeling and safety.

## HELMET SPECIFICATION

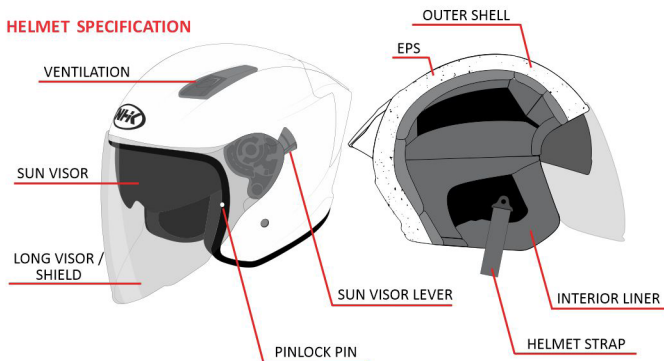

This **NHK S1 GP PRO** is available in 4 different comfort size with 2 inner shells. This chart is only for reference. Always try the helmet on and follow this manual's instructions for a proper fit. These are available size for **NHK S1 GP PRO** series :

HELMET SIZE	S	M	L	XL
HEAD CIRCUMFERENCE	55-56 CM 21.65-22.05 INCH	57-58 CM 22.44 -22.83 INCH	59-60 CM 23.23 - 23.62 INCH	61-62 CM 24.02 - 24.41 INCH

## HELMET PARTS DESCRIPTION

### 1. AIR VENTS / VENTILATION SYSTEM

NHK S1 GP PRO helmet has been designed with a good circulated air ventilation flow

- Top Vent air intake ( left and right ) distribute fresh air to the top part of the head.

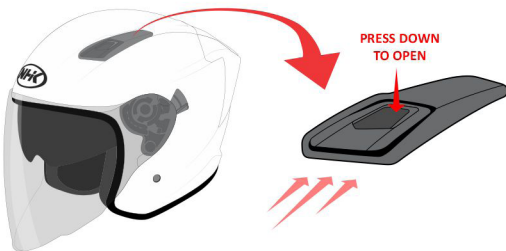

### 2. SUN VISOR SWITCH / LEVER

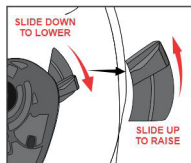

NHK S1 GP PRO equipped with Double Visor Technology to ensure extra comfort for the biker during daylight to reduce the sun brightness. This double visor switch design to be comfort and easy to use. To lower the sun visor you may switch the lever down, and to raise the sun visor you can slide the switch up.

### 3. VISOR / SHIELD

This NHK S1 GP PRO equipped with long visor shield that makes your helmet looks more elegant and sharp.

#### **WARNING!**

If the visor is damaged or deeply scratched causing reduced visibility, this means that the protective treatment is probably damaged so the visor need to be replaces. The Visor can be used for the intended helmet model only. Do not paint or apply any stickers on your visor.

#### **To Open Your Main Visor :**

- Open the visor by pressing your thumb up on the visor until it snaps open.
- Lift visor all the way up.

#### **To Close Your Main Visor :**

- Close the visor by sliding it down all the way and pressing the visor until it snaps shut.

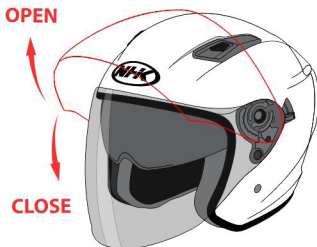

### • How To Remove NHKS1 GP PRO Visor

- Slide up the visor until completely open ( Picture 1 )
- Please make sure the visor and ratchet are in the right position ( Picture 1 )
- Push the trigger lever together (left and right) on the ratchet ( Picture 2 & 3 )
- Pull out the visor together (left and right) until released from the ratchet ( Picture 4 )
- Remove the visor safely from the helmet ( Picture 5 )

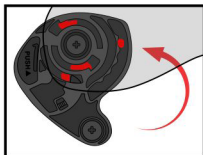

Picture 1

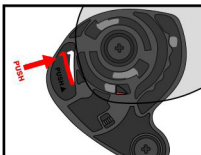

Picture 2

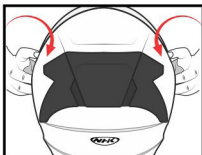

Picture 3



Picture 4

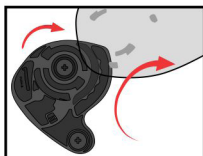

Picture 5

### • How To Install NHKS1 GP PRO Visor

- Place the visor hook on the ratchet. Please make sure visor, bracket and hook are in the right track position ( Picture 1 )
- Do the same on the other side ( Picture 2 )
- Press both sides of visor together ( Picture 3 )
- Press and then slide the visor down until the visor closed ( Picture 4 )
- Try to slide the visor up and down to make sure the visor installed correctly ( Picture 5 )

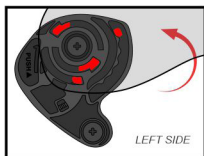

Picture 1

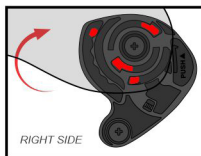

Picture 2

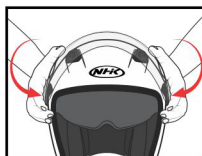

Picture 3



Picture 4

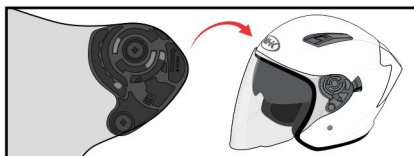

Picture 5

#### 4. PINLOCK ( ANTI FOG LENS ) \*

This **NHK S1 GP PRO** series equipped with Pinlock Pin on the visor. You can add and install NHK Pinlock® 70 lens. Pinlock® 70 lens is made from a moisture absorbing plastic. The Pinlock® lens fits exactly into the dedicated recess in the helmet shield and provides you with a maximized free field of view. The silicon seal on the Pinlock® lens creates an insulating air pocket between the Pinlock® lens and the helmet shield. The pins, between which the Pinlock® lens is to be fitted, are eccentric, which means that the axis of the pin is not precisely in the center. This enables you to increase or decrease the tension on the Pinlock® lens by turning the pins, allowing the silicone seal to have a perfect fit. Please notice! The Pinlock® lens is less resistant to scratching than the helmet shield!

#### 5. RETENTION SYSTEM ( CHINSTRAP ) \*

##### • Double D Ring Strap

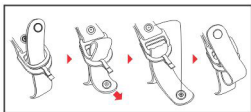

##### How To Fasten :

- Slot the tape through the two rings
- Pull the end of the tape until the strap pressed against the jaw
- Fasten the anti flapping press stud and then check that the helmet fits snugly

##### How To Release :

To release the helmet, unfasten the press stud by pulling on the end of the tape and loosen the tape by sliding it through the rings, using the red tab.

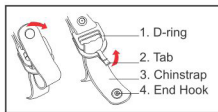

##### • Micromatic Buckle Strap :

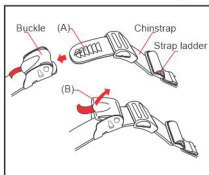

- To fasten the strap, push the long tongue firmly into the buckle until it locks with a click. Pull chinstrap tight against your throat and the end of chinstrap ladder to secure it.
- To release the chinstrap, lift up the red lever and then release the lock.

#### 6. NHK HELMET INNER LINING

With the comfort inner lining system, we bring you a completely new development in regards to; noise reduction, ventilation, and fitment. The innovative soft mesh material forms around the curves of your head, this way the material does not only feels soft on your skin but also stays firmly placed. To clean your interior padding, use only mild soap and water to wash the interior of your helmet. Never allow your helmet to come in contact high chemical liquid. Do not use washing machine and hot water to clean and wash.

## • CHEEK PADS & CROWN PAD

Sometimes some part of helmet inner lining may require removal for washing or replacement.

### How To Remove Cheek Pads :

- Put your fingers behind the cheek pads
- Gently tug the cheek pads away from the helmet interior wall
- There are 3 snaps that require unsnapping. At the same time slide the plastic trim out the helmet grip
- Do the same on the other side

### How To Remove Crown Pad :

- Remove the cheek pads
- From the back side of the helmet, pull the crown pad away from the shell
- Then pull the crown pad out of the helmet gently

### How To Install Cheek Pads and Crown Pad :

- To re-install cheek pads and crown pad please reverse this process.

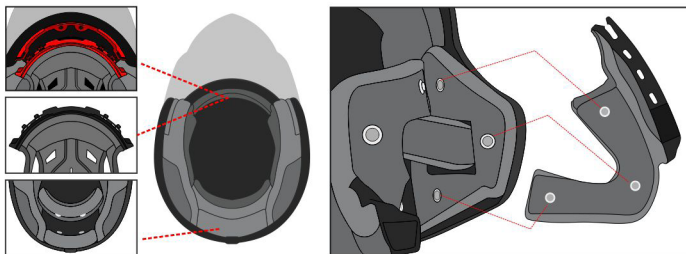

## **WARNING!**

No helmet can protect the user from all possible and foreseeable impacts. However, for adequate protection, this NHK helmet must fit closely and the retention system must be securely attached. The helmet shall not easily removed when its fitted and fastened. Do not apply paint, substances and any other solvent to this helmet. Helmet can be seriously damaged. To maintain full efficiency of the helmet, please do not make any modification on helmet parts and structure. If the helmet has experience a severe impact the helmet should be replaced.



SCAN ME

[www.NHKhelmet.com](http://www.NHKhelmet.com)